

OPTIMA: the optimal value for money.

Characteristics

- Surpasses the number of required code differences by a multiple
- Protected against scanning and knocking off
- Theoretical number of codes: 823,543

Composition of lock

- Lock: right-hand
- Lock case: die-cast zinc
- Bolt: deadbolt with 2 holes, die-cast zinc
- Bolt hub: 12 mm
- Lock cover: screwed
- Levers: 8
- Fixing points: standard

Certification

- EN 1300 A
- VdS Class 1
- A2P Niveau A (E)
- IMP Class A
- ECB•S

Application range

- Safety cabinet according to EN 11450 S1, S2
- Safes according to EN 1143-1 Grade 0 to II
- Examples
 - Hotel safes, small safes and home safes
 - Gun cabinets
 - Inner compartments, drawers, shelf doors
 - Furniture safes



Optima 2648-01-0-Z065-2

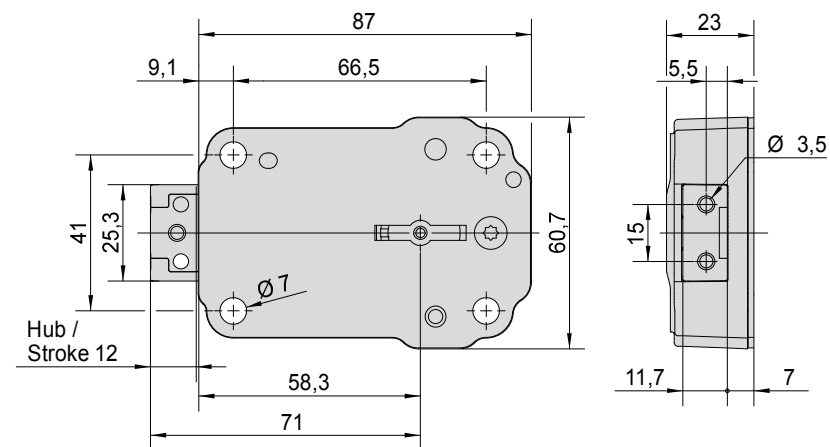

Installation of Optima 2648 with bolt ledge



Basic lock 2648	Key		
Article number	Material	Length (mm)	Number
2648-01-0-Z065-2	Die-cast zinc	65	2
2648-01-0-Z065-4	Die-cast zinc	65	4
2648-01-0-Z095-2	Die-cast zinc	95	2
2648-01-0-Z095-4	Die-cast zinc	95	4
2648-01-0-Z120-2	Die-cast zinc	120	2
2648-01-0-Z120-4	Die-cast zinc	120	4
2648-01-0-Z145-2	Die-cast zinc	145	2
2648-01-0-Z160-2	Die-cast zinc	160	2
2648-01-0-M094-2	Brass	94	2